



GENERAL NOTES:

1. SURVEY INFORMATION PROVIDED BY BLAIS SURVEYING COMPANY, NEWPORT, VERMONT
2. TOPOGRAPHIC FEATURES AND CONTOURS DERIVED FROM CLOSED TRAVERSE ELECTRONIC TOTAL STATION FIELD MEASUREMENTS TIED TO MONUMENTS OF KNOWN VERMONT STATE PLANE COORDINATES NAD 1983 ESTABLISHED BY OTHERS
3. CONTOUR ELEVATIONS REFERENCED TO N.G.V.D. 88. CONTOUR INTERVAL IS 2'.
4. REFERENCE VELCO SUBSTATION DRAWING 209-6100D, DATE 10/18/04

GENERAL PLANTING NOTES:

1. THE CONTRACTOR SHALL LOCATE AND VERIFY THE EXISTENCE OF ALL UTILITIES PRIOR TO STARTING WORK.
2. THE CONTRACTOR SHALL SUPPLY ALL PLANT MATERIAL IN QUANTITIES SUFFICIENT TO COMPLETE THE PLANTING SHOWN ON ALL DRAWINGS.
3. ALL MATERIAL SHALL CONFORM TO THE GUIDELINES ESTABLISHED BY THE CURRENT AMERICAN STANDARD FOR NURSERY STOCK (ANSI) PUBLISHED BY THE AMERICAN ASSOCIATION OF NURSERMEN.
4. NO PLANT SHALL BE PUT INTO THE GROUND BEFORE ROUGH GRADING HAS BEEN FINISHED AND APPROVED BY THE PROJECT ARCHITECT OR EQUAL.
5. ALL PLANTS SHALL BEAR THE SAME RELATIONSHIP TO FINISHED GRADE AS THE PLANTS ORIGINAL GRADE BEFORE DIGGING.
6. ALL PLANTS SHALL BE BALLED AND WRAPPED OR CONTAINER GROWN AS SPECIFIED. NO CONTAINER GROWN STOCK WILL BE ACCEPTED IF ITS IS ROOT BOUND. ALL ROOT WRAPPING MATERIAL MADE OF SYNTHETICS OR PLASTICS SHALL BE REMOVED AT TIME OF PLANTING.
7. WITH CONTAINER GROWN STOCK, THE CONTAINER SHALL BE REMOVED AND THE CONTAINER BALL SHALL BE CUT THROUGH THE SURFACE IN TWO VERTICAL LOCATIONS.
8. THE DAY PRIOR TO PLANTING, THE LOCATION OF ALL TREES AND SHRUBS SHALL BE STAKED FOR APPROVAL BY THE PROJECT LANDSCAPE ARCHITECT OR EQUAL.
9. ALL PLANTS SHALL BE SPRAYED WITH AN ANTIDESICCANT WITHIN 24 HOURS AFTER PLANTING. IN TEMPERATE ZONES, ALL PLANTS SHALL BE SPRAYED WITH AN ANTIDESICCANT AT THE BEGINNING OF THEIR FIRST WINTER.
10. ALL PLANTS SHALL BE INSTALLED AS PER DETAILS AND THE CONTRACT SPECIFICATIONS.
11. ALL PLANTS AND STAKES SHALL BE SET PLUMB UNLESS OTHERWISE SPECIFIED.
12. THE LANDSCAPE CONTRACTOR SHALL PROVIDE FILL AS PER THE CONTRACT SPECIFICATIONS.
13. ALL PLANTS SHALL BE WATERED THOROUGHLY TWICE DURING THE FIRST 24 HOUR PERIOD AFTER PLANTING. ALL PLANTS SHALL THEN BE WATERED WEEKLY IF NECESSARY, DURING THE FIRST GROWING SEASON. THE LANDSCAPE CONTRACTOR SHALL REFER TO THE CONTRACT SPECIFICATIONS FOR ADDITIONAL REQUIREMENTS.
15. THE LANDSCAPE CONTRACTOR SHALL REFER TO THE PLANT LIST FOR SEASONAL REQUIREMENTS RELATED THE THE TIME OF PLANTING.

LANDSCAPING LEGEND

-  PROPOSED EVERGREEN TREE
-  VEGETATION TO BE REMOVED

MIDDLESEX SUBSTATION PLANTING SCHEDULE

TREES & SHRUBS	Scientific Name	Common Name	Size	Spec	Notes	Growth Rate	Maximum Height
8	Fg	White Spruce	6'-7' Ht.	B&B	10' & c.	Medium	50'-70'

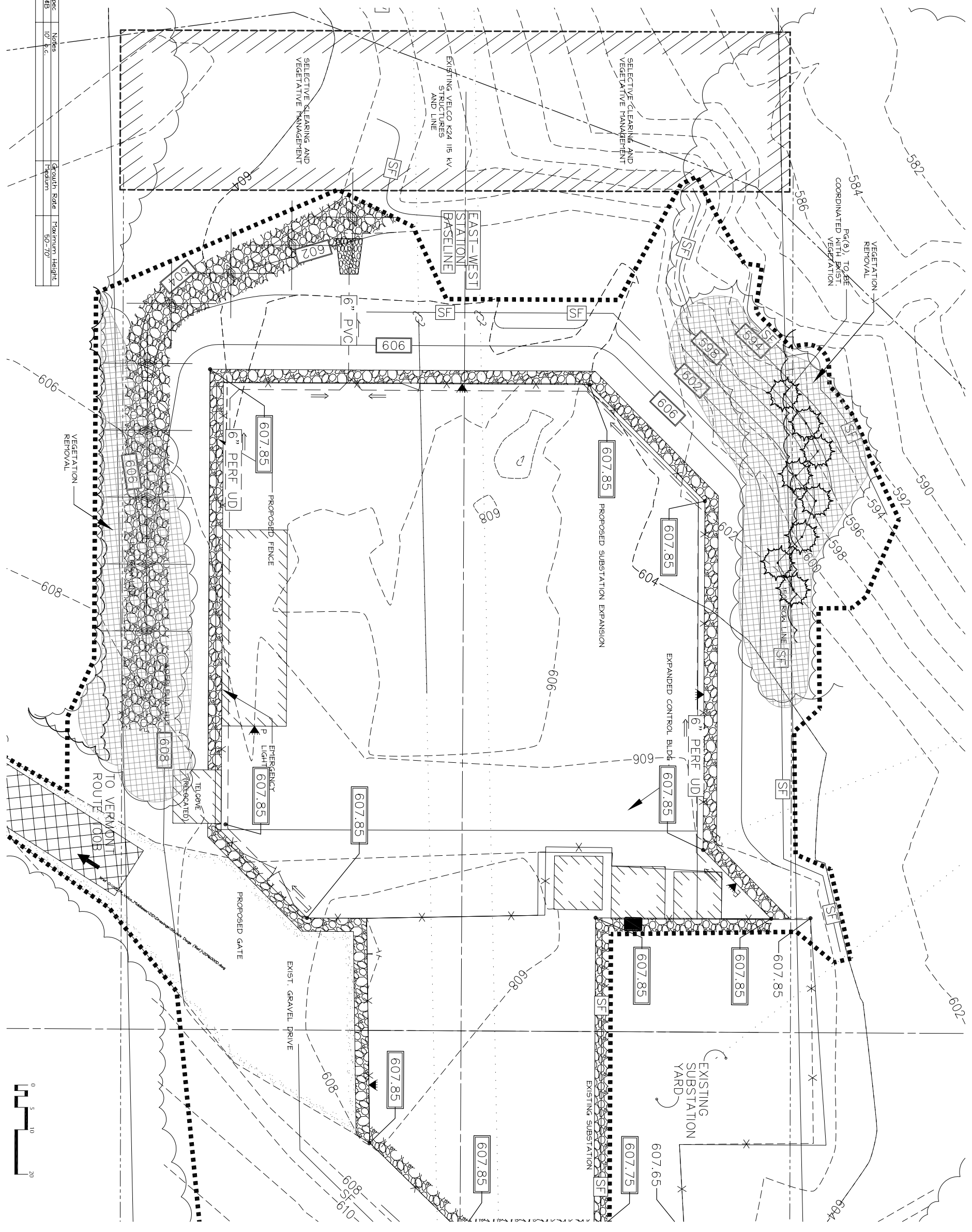

<table border="1"> <tr> <th>revisions</th> <th>date</th> <th>revisions</th> <th>date</th> </tr> <tr> <td>revised planting - law</td> <td>06-29-06</td> <td></td> <td></td> </tr> </table>	revisions	date	revisions	date	revised planting - law	06-29-06			VELCO 366 Pinnacle Ridge Road Rutland, Vermont	landscape architects • planning consultants 301 college street • Burlington • Vermont • 05401 802-656-3555 <a href="http://www.jfpjpa.com">http://www.jfpjpa.com</a>	amp 13/20/04 1" = 10' VELCO Lamotte County Project Middlesex Substation - Mitigation Planting Plan	1
revisions	date	revisions	date									
revised planting - law	06-29-06											